

# Pro-Line 28 / 50 FU

QUICK START GUIDE

EN

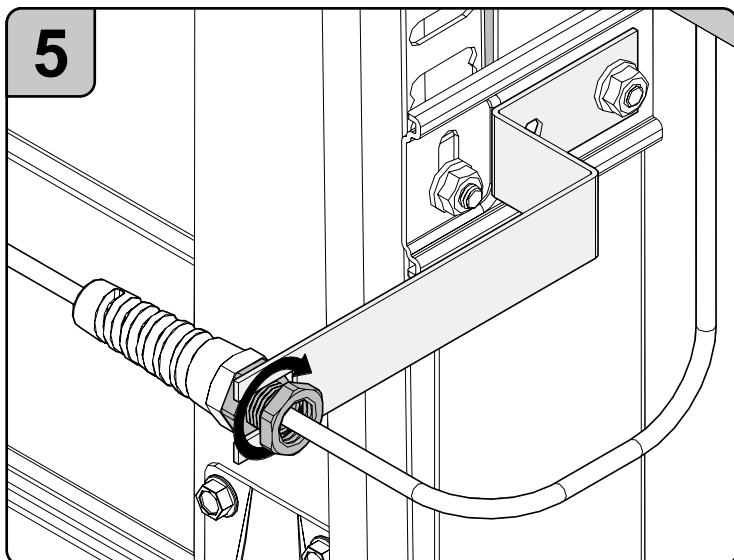

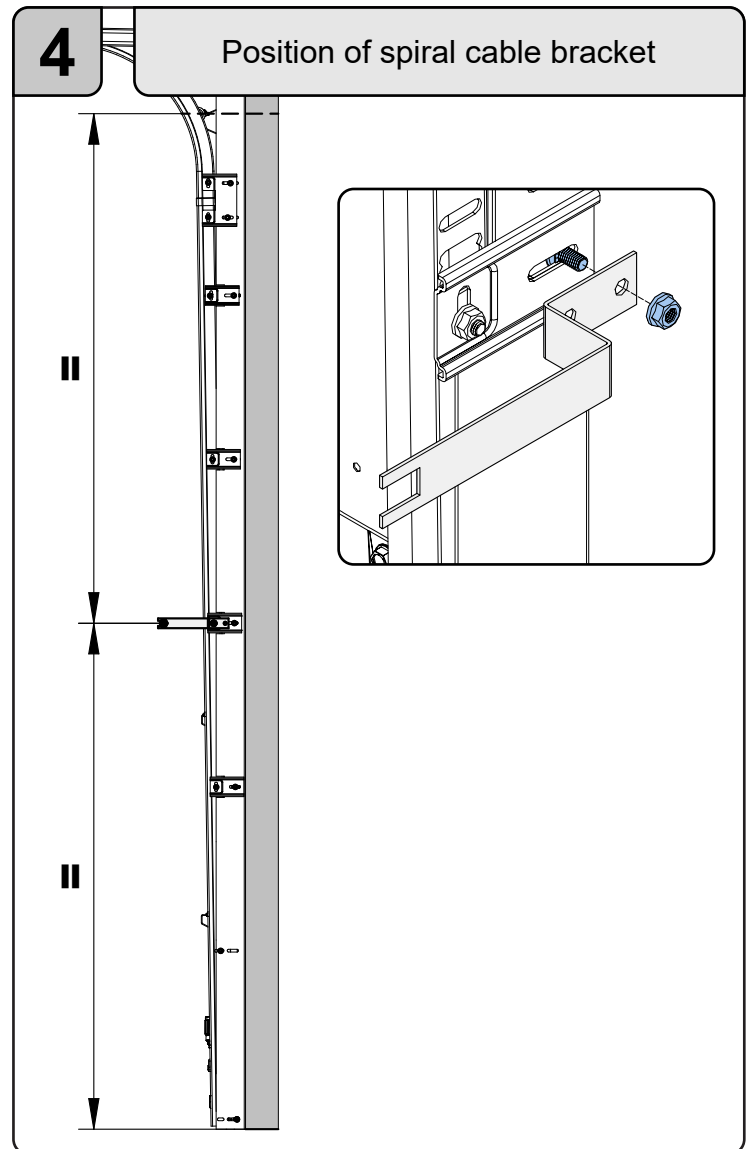
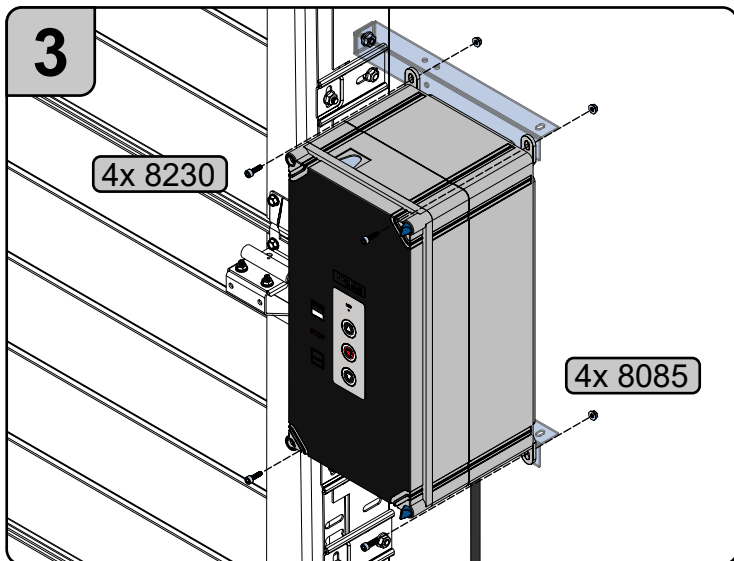
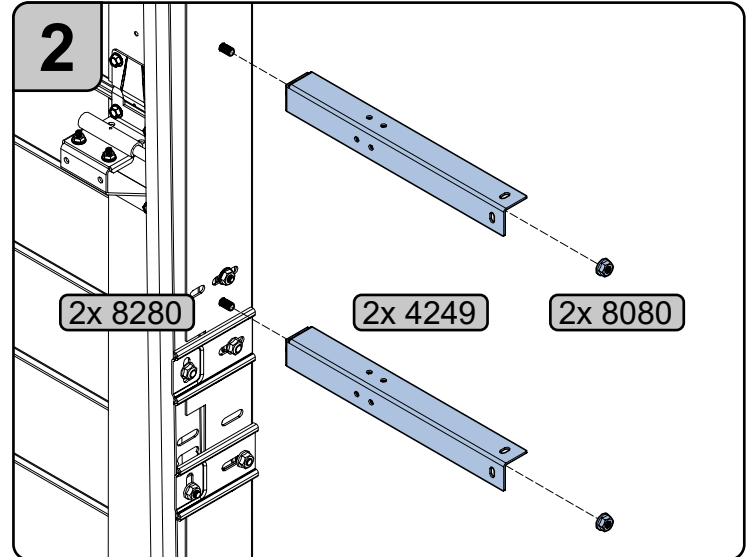
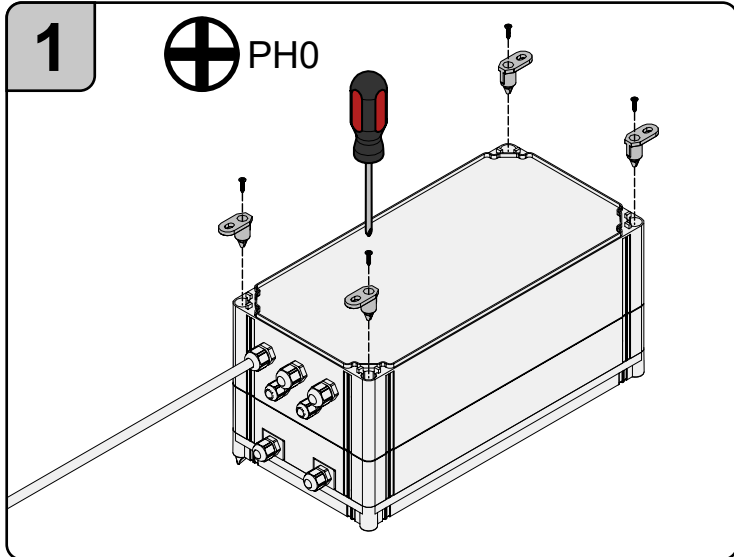
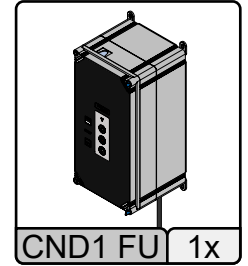
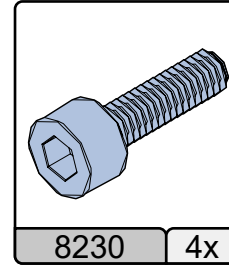
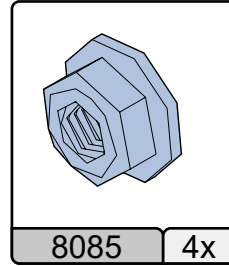
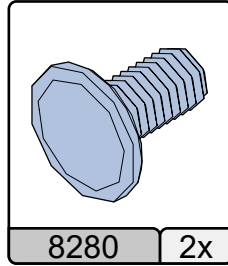
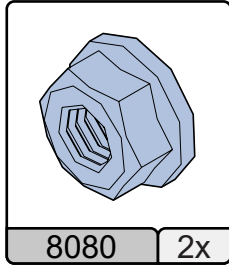
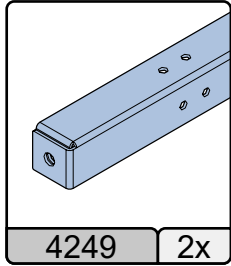

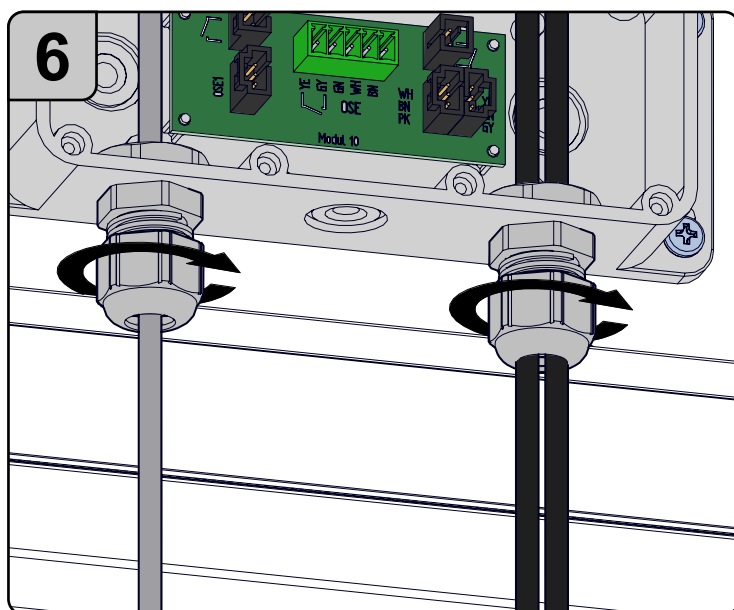
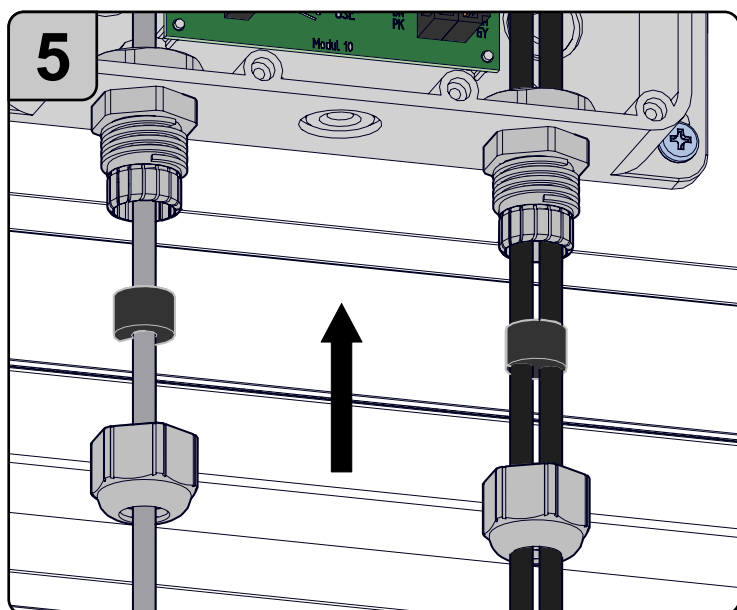
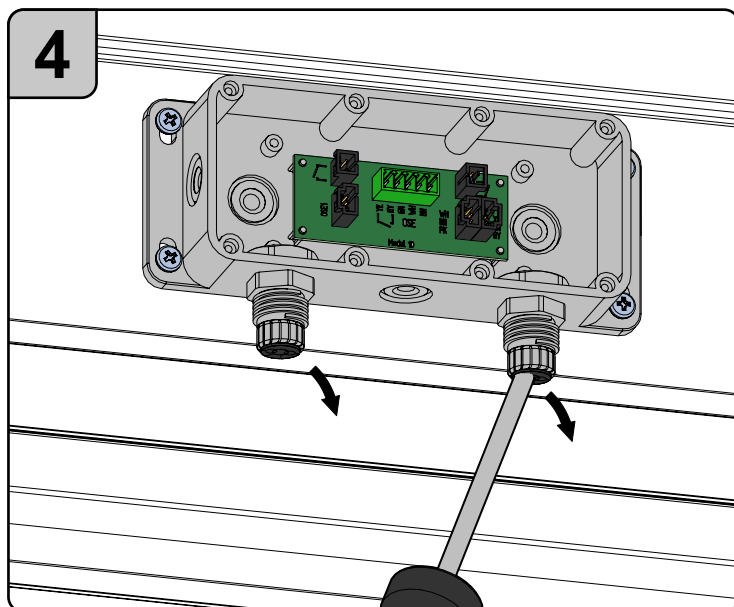
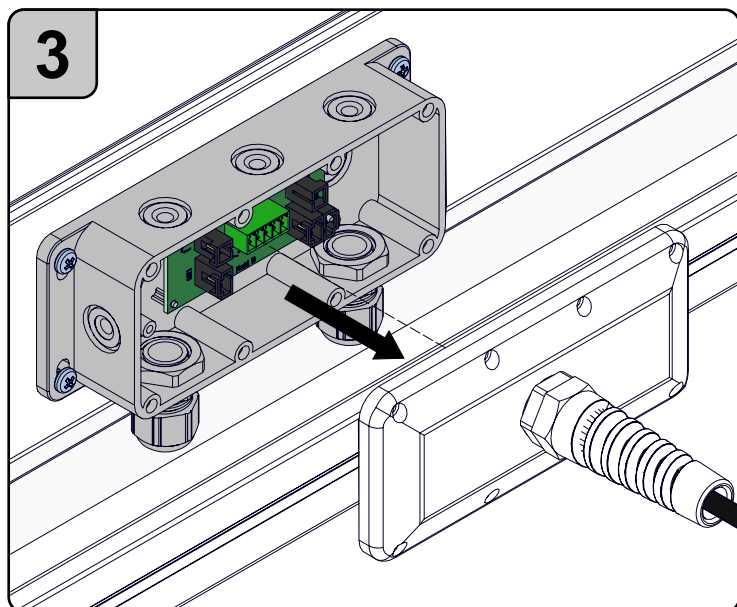
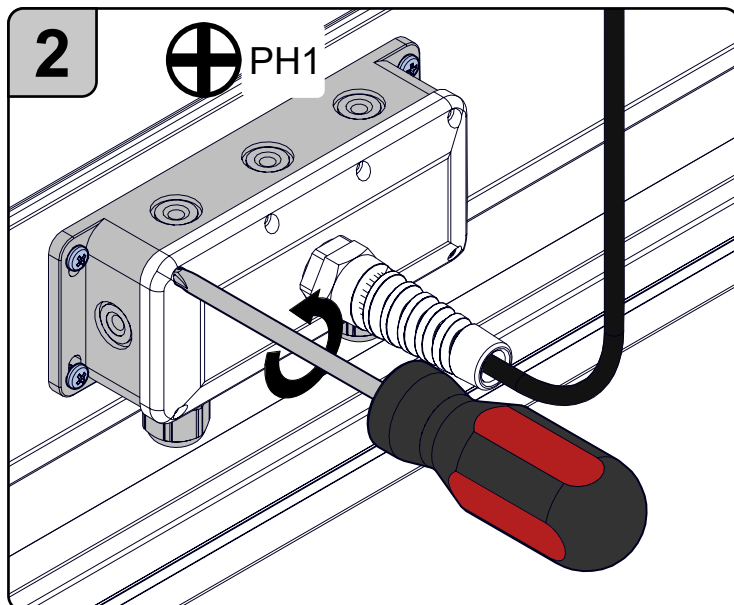
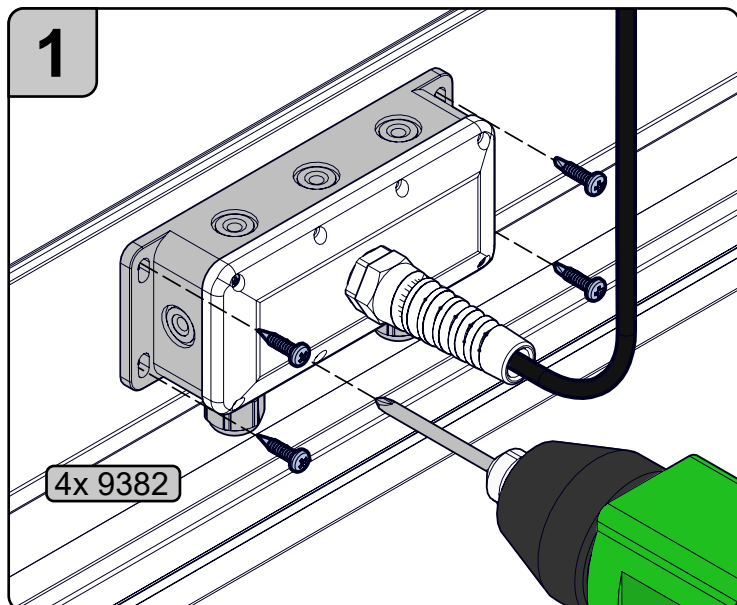

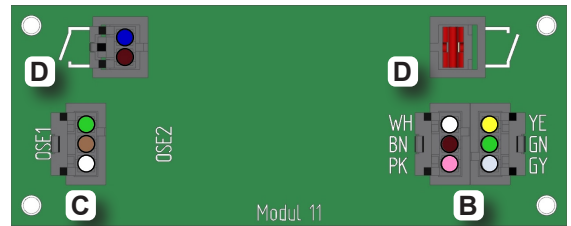
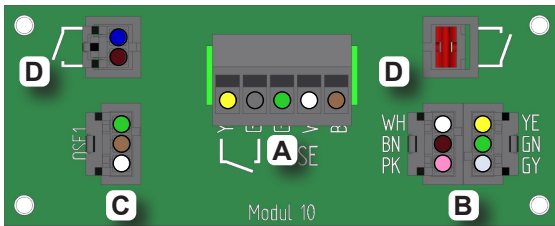
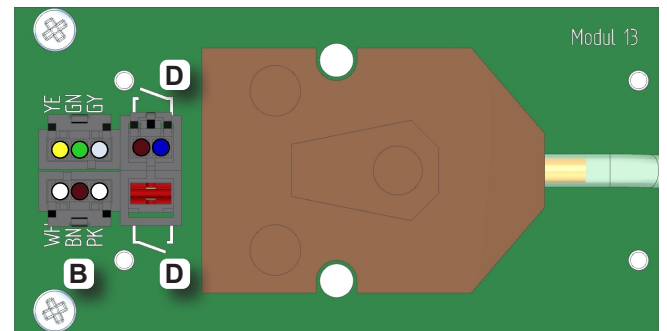
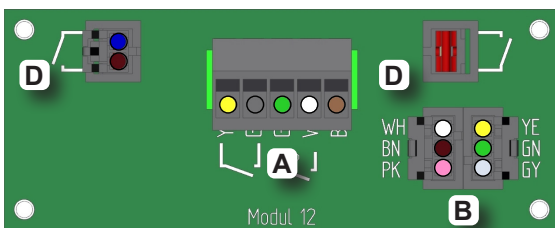
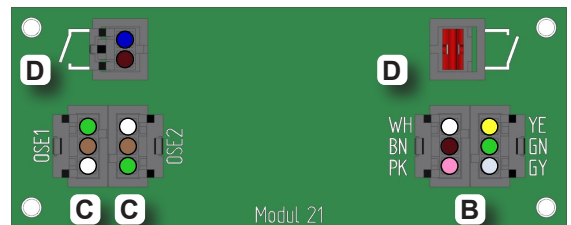
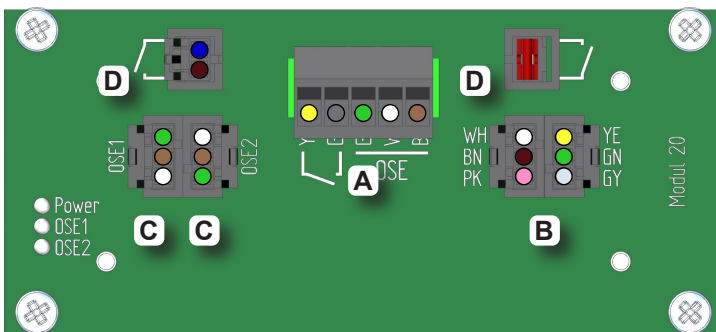
**Opto: Module 10 + 11****DW: Module 12 + 13****Duo Opto: Module 20 + 21****Connections**

- A = Spiral cable
- B = Connecting cable
- C = OPTO / OSE1 / OSE2
- D = SCD L/R / PD Switch

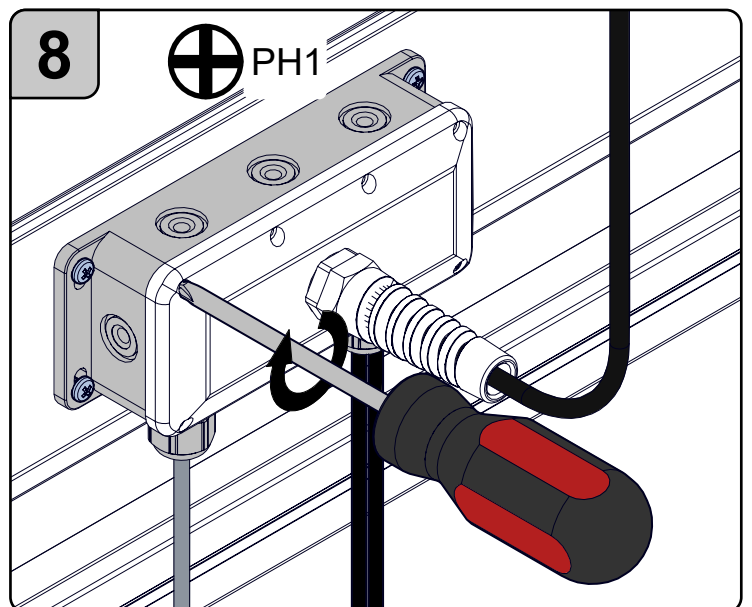

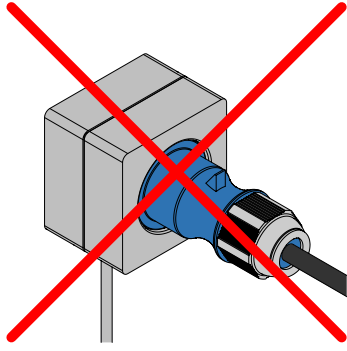

**NOTE! Do not plug in CEE plug yet!**

**1**

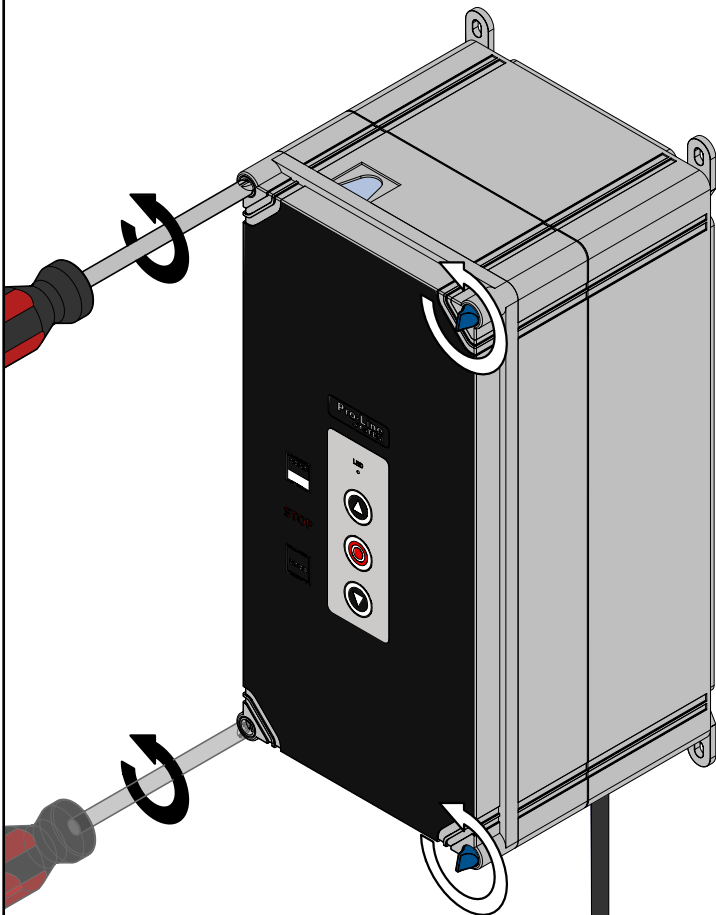

**2**

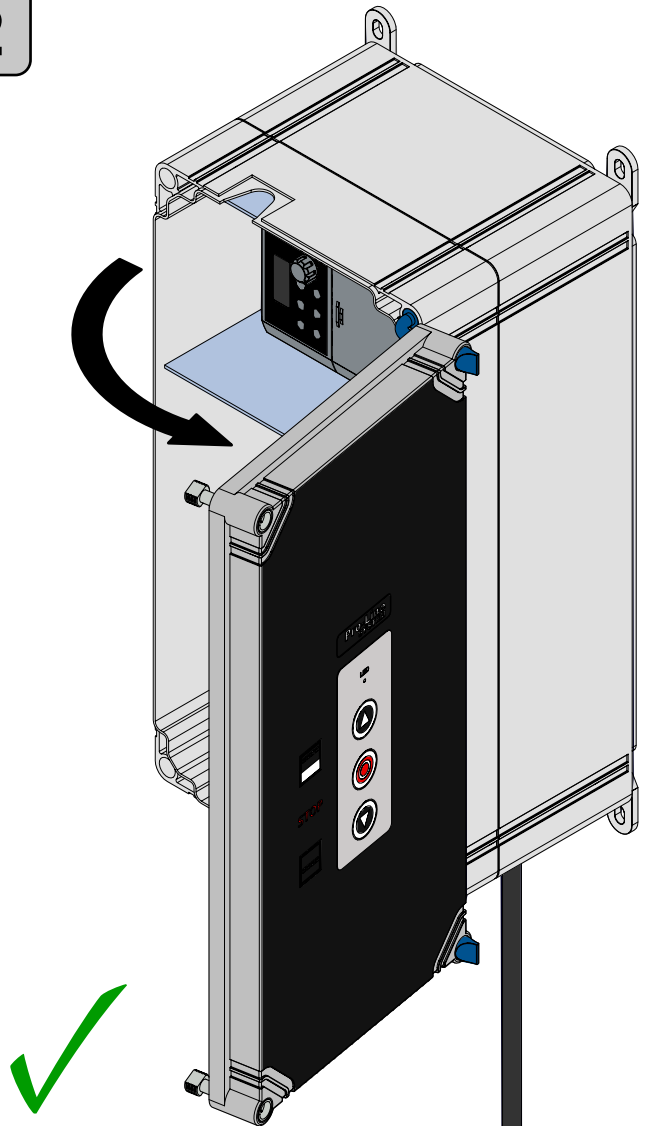

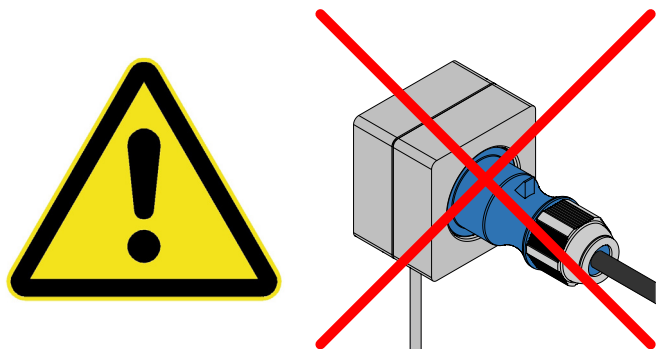

**NOTE! Do not plug in CEE plug yet!**

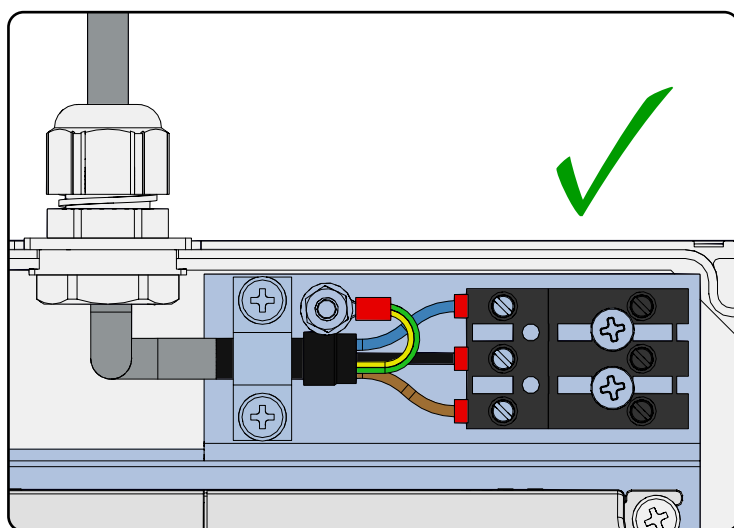
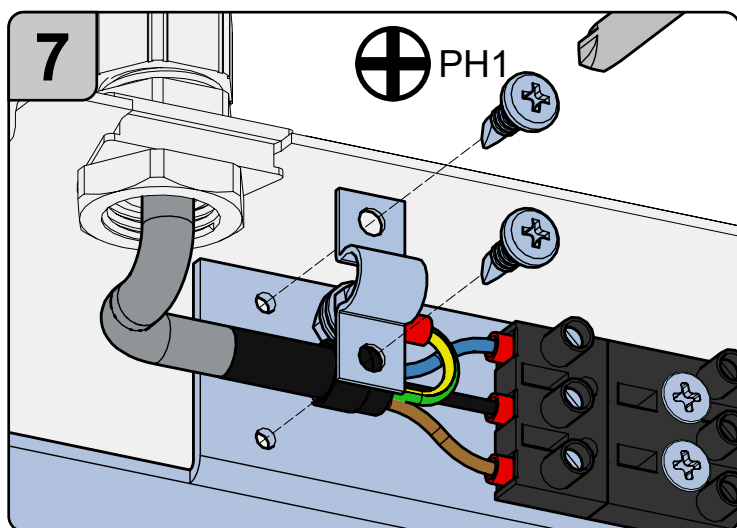
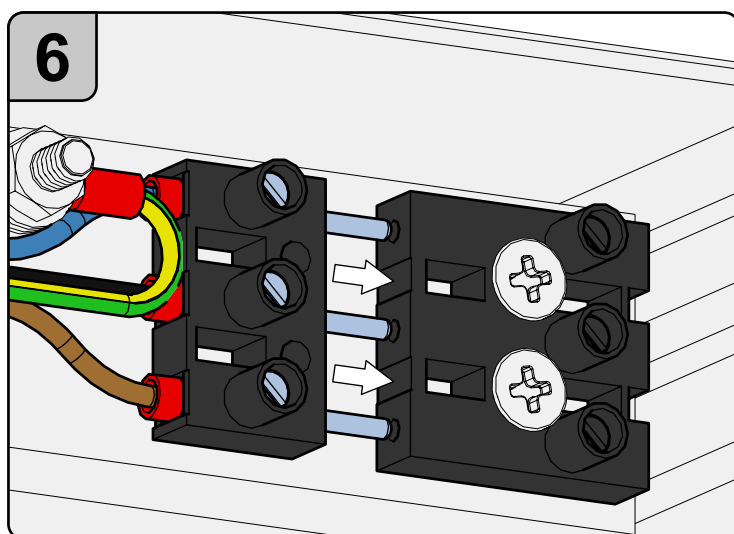
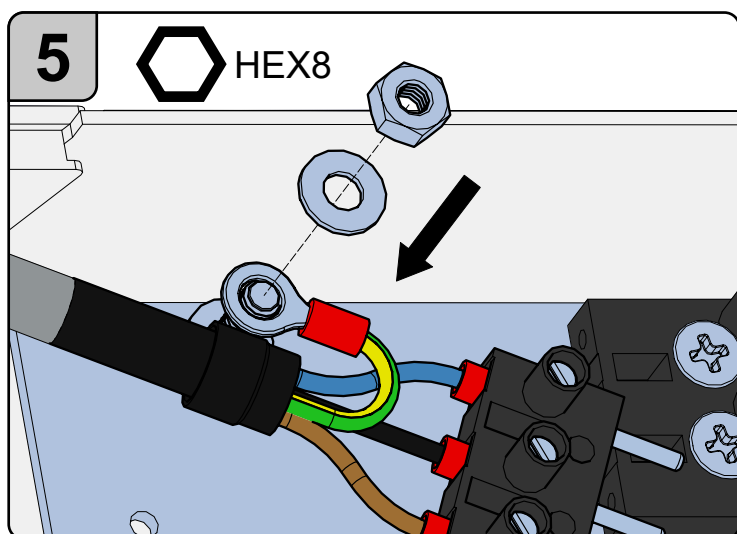
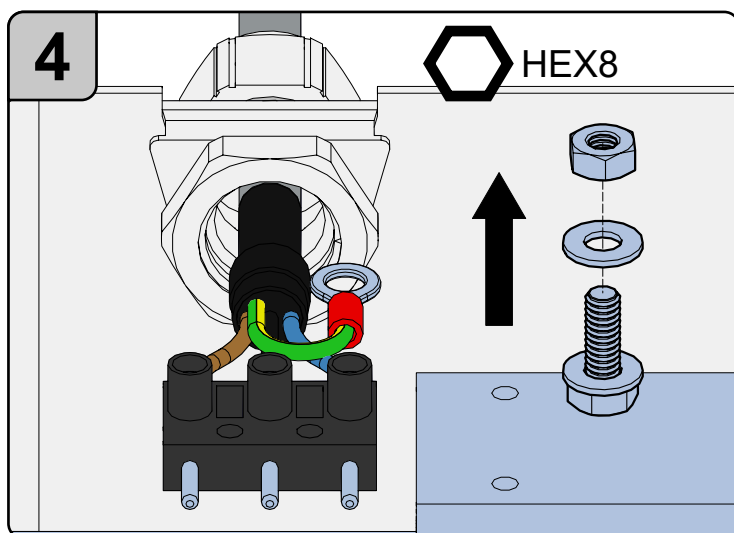
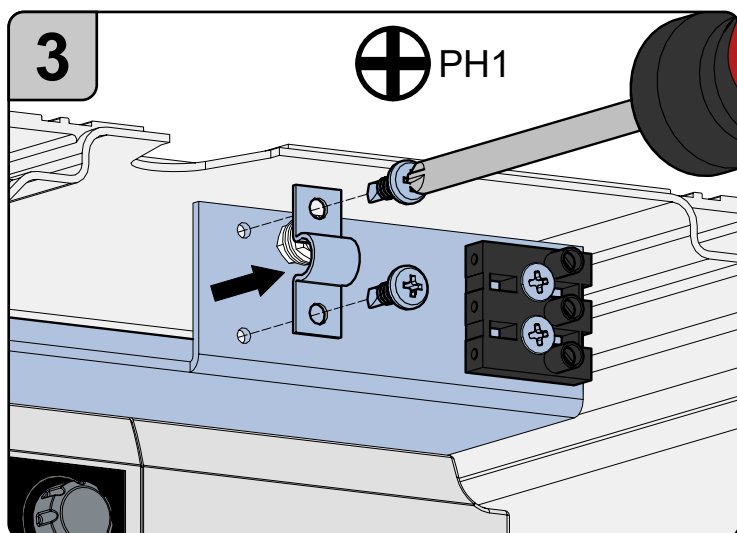



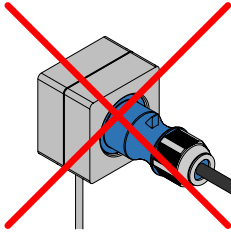

**NOTE! Do not plug in CEE plug yet!**

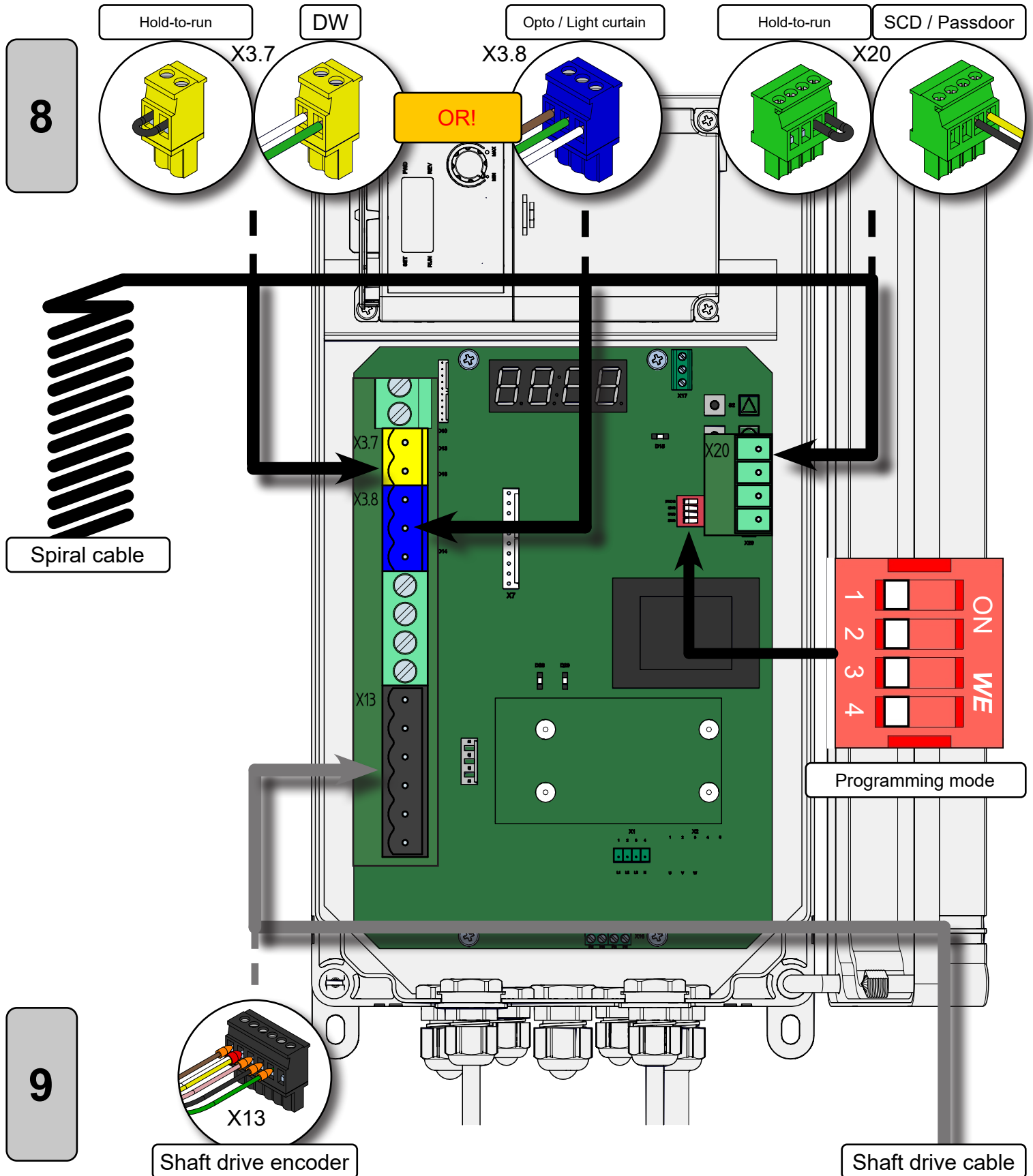

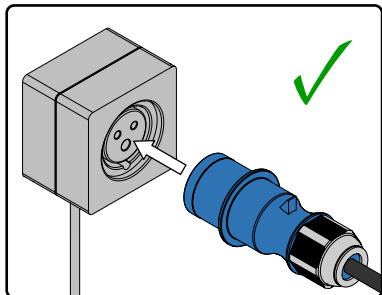

**NOTE!** Plug in the CEE plug to program the control box.

### Activate programming mode

**1**

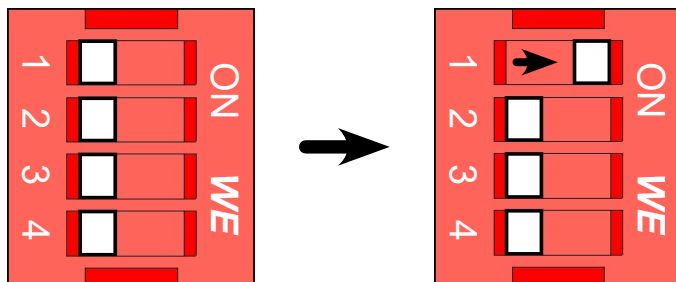

Move switch 1 to ON

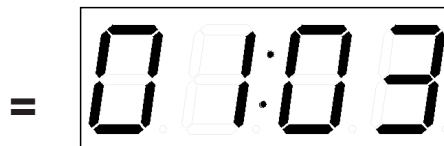

Display

### Determine open door position

**2**

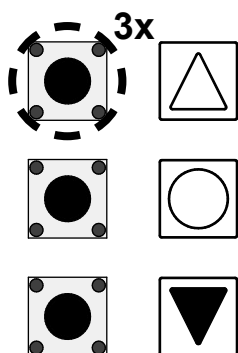

Until  
Display:



**3**

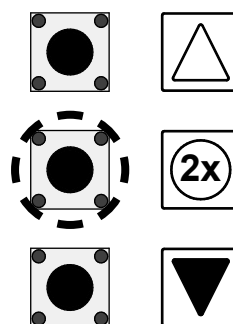

=  
Display:



**4**

Keep  
pressed

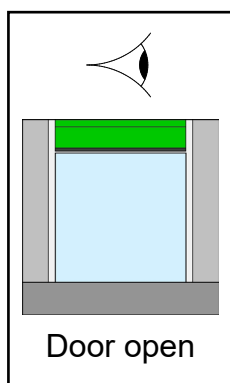
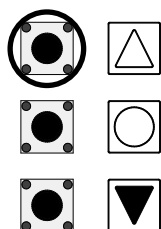

Release  
button

**5**

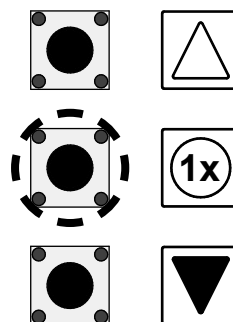

=  
Display:

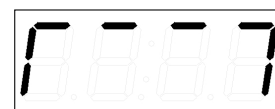

4 sec.



## Determine closed door position

6

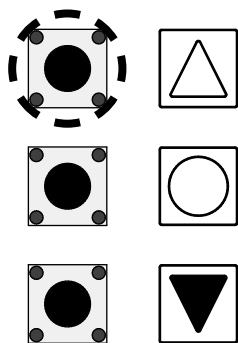
Until  
Display:

7

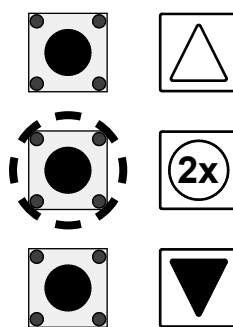
=  
Display:

8

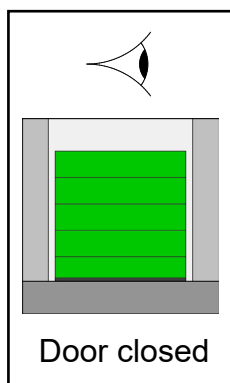
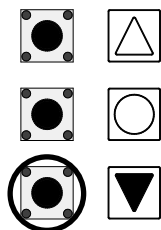
Keep  
pressedRelease  
button

9

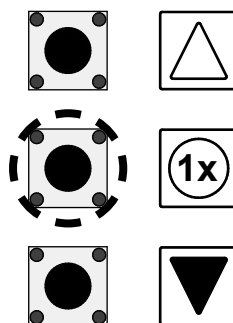
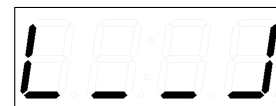
=  
Display:

4 sec.

## Exit programming mode

10

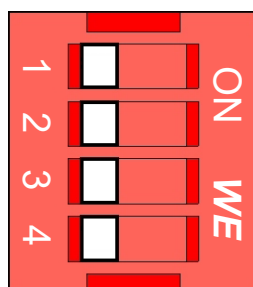
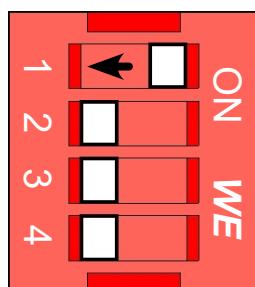

Move Switch 1 to OFF

## Check the operation of the door

11

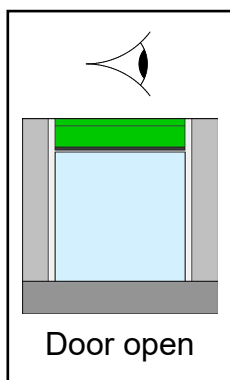
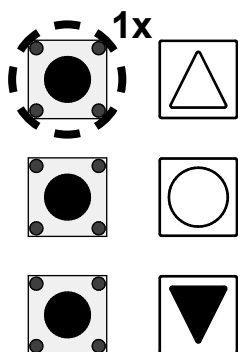

12

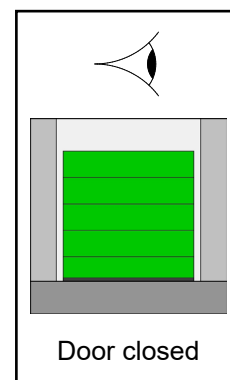
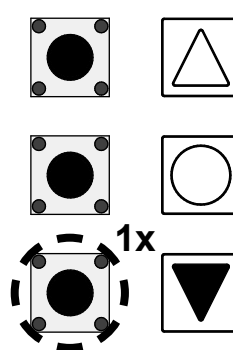

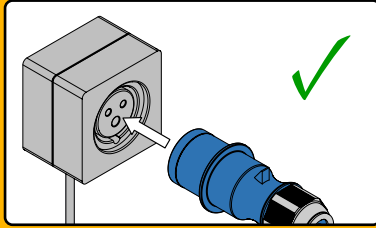

**NOTE! Plug in the CEE plug to adjust Inverter settings.**

**NOTE!** The admissible closing speed must be adjusted to comply with European standard EN12453.

**NOTE!** Raising the opening or closing frequency will increase wear and tear on moving hardware parts.

Illustration: Inverter controls



### Adjust door opening frequency

Step	Press		Display
			80.00
1)	ENT	1x	80.00
2)	MODE SHIFT	3x	80.00
3)	Up Arrow	x *	70.00
4)	ENT	2x	70.00
✓	* Until desired frequency shows on display		

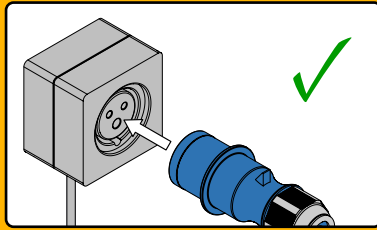

**NOTE! Plug in the CEE plug to adjust Inverter settings.**

**NOTE! The admissible closing speed must be adjusted to comply with European standard EN12453.**

**NOTE! Raising the opening or closing frequency will increase wear and tear on moving hardware parts.**

### Adjust door closing frequency 1/2

Step	Press	Display
		** 60.00
1)	↓ 1x	00.0
2)	ENT 1x	00.00
3)	↑ 1x	00.01
4)	ENT 2x	00.0
5)	↑ 1x	** 60.00
✓	** Shows door opening frequency	

### Adjust door closing frequency 2/2

Step	Press	Display
		** 60.00
1)	MODE SHIFT 2x	6A.0
2)	↑ 12x	6A51
3)	ENT 1x	50.00
4)	MODE SHIFT 3x	50.00
5)	↓ x *	40.00
6)	ENT 2x	6A51
7)	MODE SHIFT 10x	** 60.00
✓	* Until desired frequency shows on display	
	** Shows door opening frequency	

Available settings

Soft stop door open: Parameter 91		Soft stop door closed: Parameter 92	
91:00	5% before open door position	92:00	5% before closed door position
91:01	10% before open door position	92:01	10% before closed door position
91:02	15% before open door position	92:02	15% before closed door position
91:03	20% before open door position	92:03	20% before closed door position
Default setting		Default setting	

Illustration: Opening / Closing speed

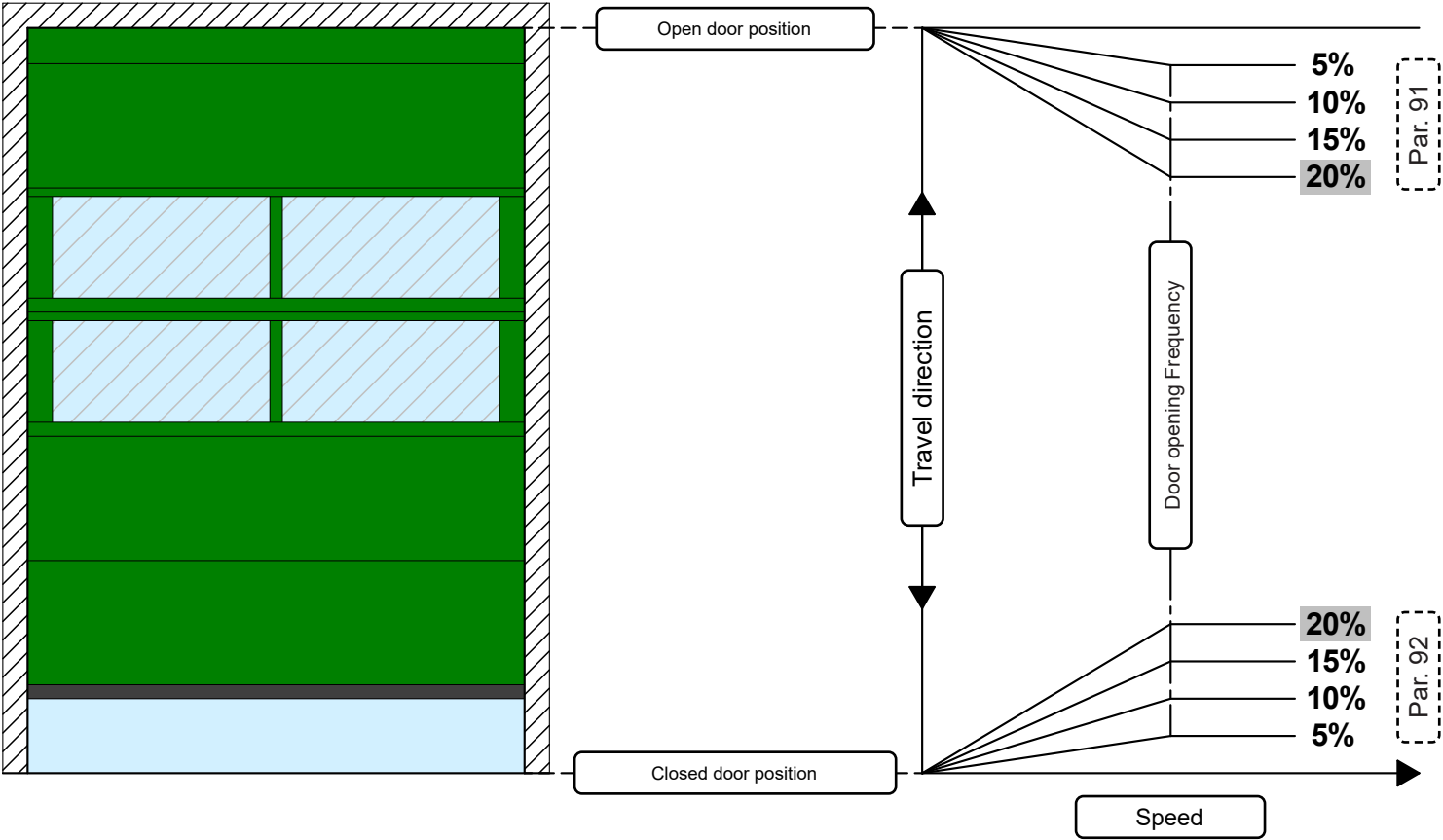

User manual

Activate programming mode

1

1

2

3

4

ON

WE

→

1

2

3

4

ON

WE

=

0

1

:

0

3

Display

Move switch 1 to ON

## Set parameter 91

2

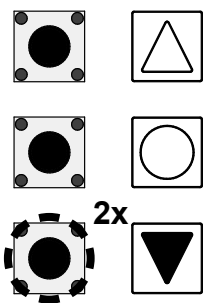

Until  
Display:

91:03

3

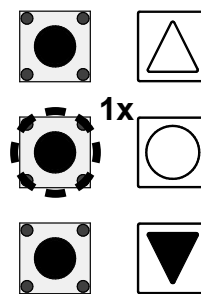

4

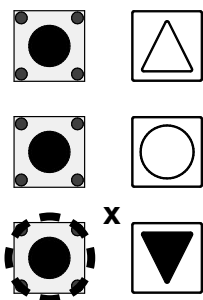

Until  
Desired setting:

91:02

5

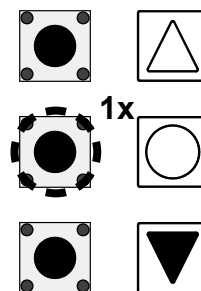

## Set parameter 92

6

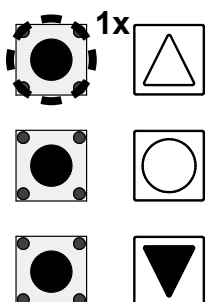

Until  
Display:

92:03

7

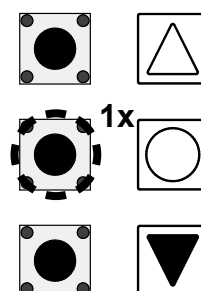

8

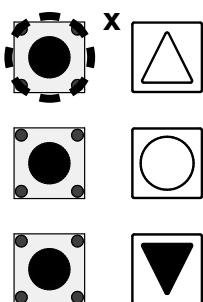

Until  
Desired setting:

92:02

9

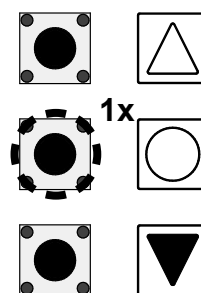

## Deactivate programming mode

10

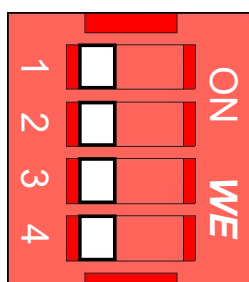
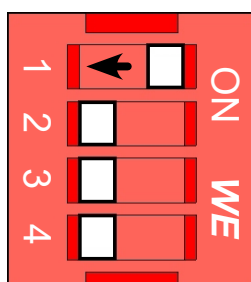

Move switch 1 to OFF

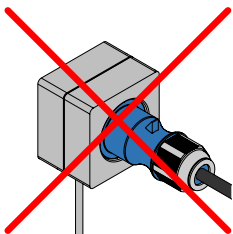

**NOTE!** Only plug in the CEE plug and peripheral equipment after connecting all of the plug-in plugs in the way described below.

1

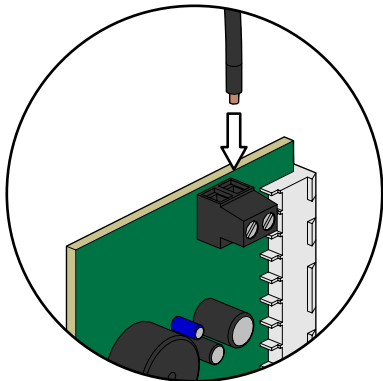

2

X7

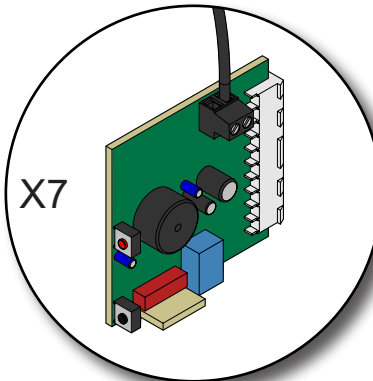

**NOTE!** Insert the plug-in circuit board firmly to ensure a good contact.

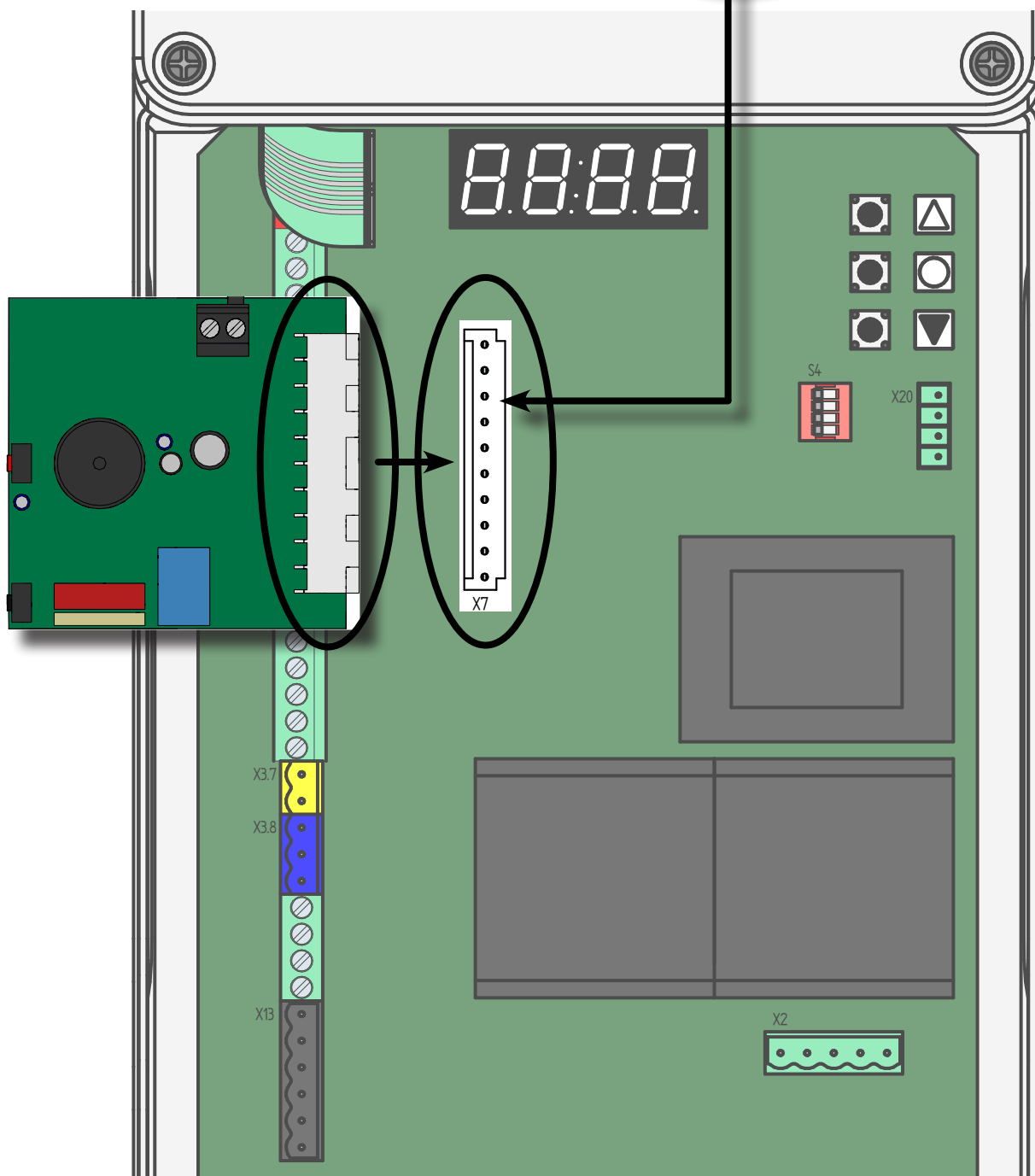

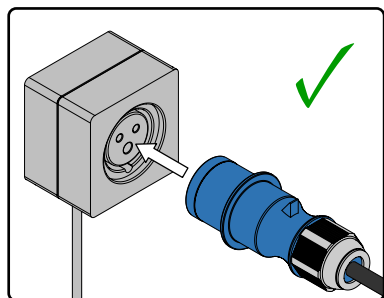

**NOTE! Plug in the CEE plug to be able to connect to the remote control.**

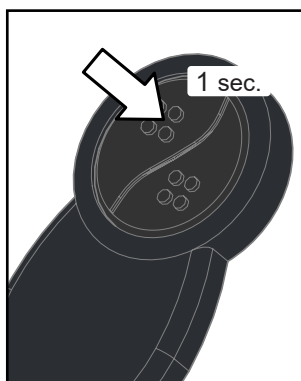
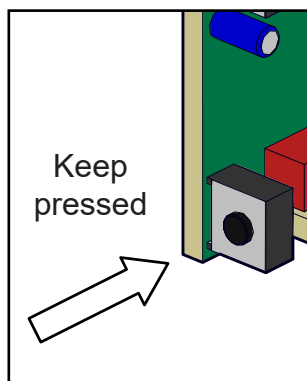
**1**

A sound will be made as long as the button on the plug-in circuit board is pressed. At the same time, press the button on the remote control!

Test the operation of the remote control. Repeat the connection procedure if it does not work.

### Pro-Line 28/50 CND1 - Disconnecting the remote control

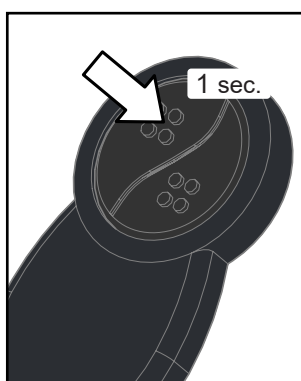
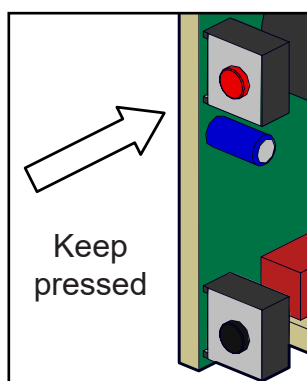
**1**

A sound will be made as long as the button on the plug-in circuit board is pressed. At the same time, press the button on the remote control!

Test the operation of the remote control. Repeat the disconnection procedure if it does not work.

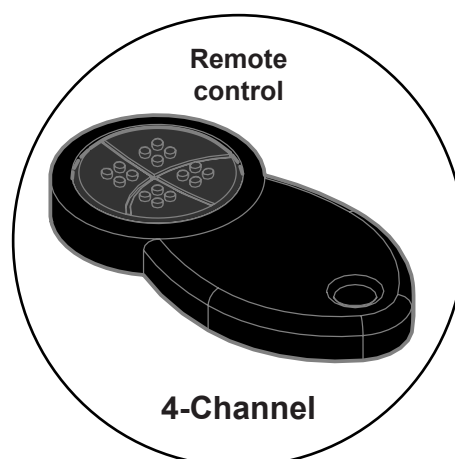
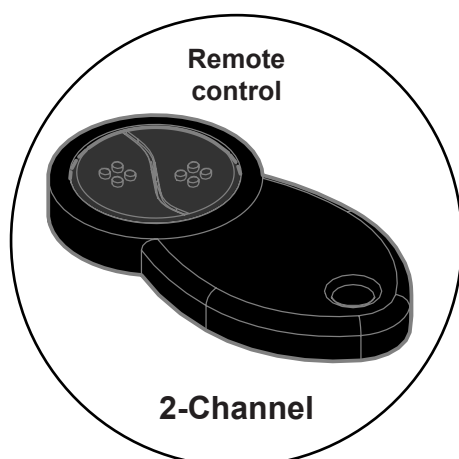



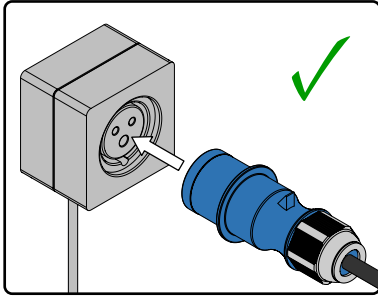

**NOTE! Plug in the CEE plug!**

### Switch DIL switch

**1**

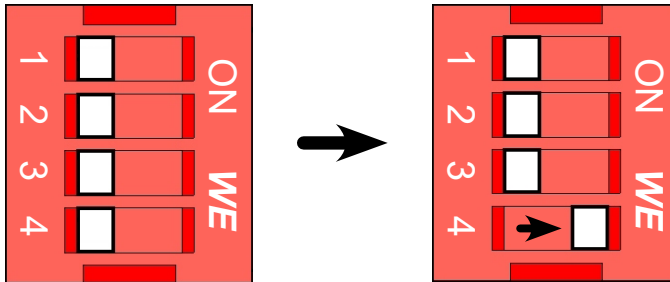

Move switch 4 to ON

Display:

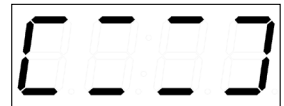

### Reinstall CND1 factory settings

**2**

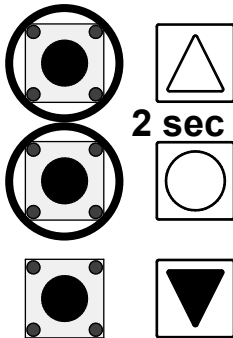

Display:



Display:

Version Number

Display:

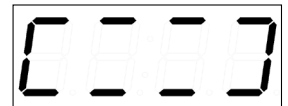

### Move DIL switch to OFF

**3**

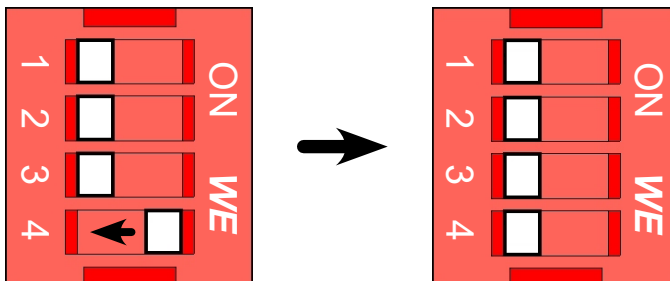

Move Switch 4 to OFF

